



PJM Connect Roadmap

As of July 15, 2020

- Due to the recent RTO-wide Hot Weather Alert, the release date for this change has been rescheduled to Thursday, July 16 at 5:00 p.m. to Friday, July 17 at 8:00 a.m.

Product - Action Required	Dates	Who May Be Affected
<p>Implementation: PJM Connect integration with PJM’s Single Sign On (SSO)</p> <ul style="list-style-type: none"> • Share this communication internally within your organization. • Prior to maintenance, download any information that may be needed as log in to PJM Connect will be unavailable during this time. 	<p>July 16 5:00 p.m. – July 17 8:00 a.m.</p>	<p>PJM Connect users</p>



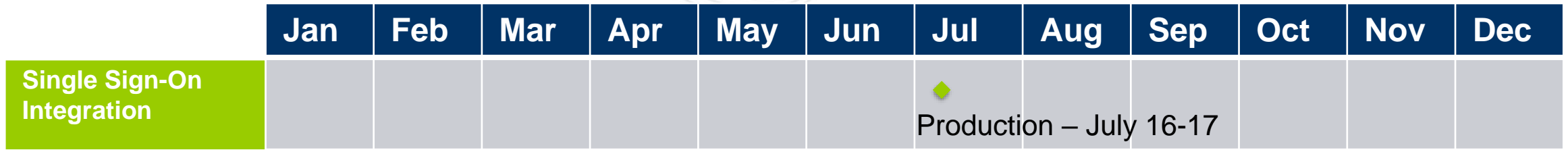

Legend

- Start Date
- ◆ End Date



Previously, PJM Connect prompted users for their accounts via the web browser and use the following format: DMZ\username

After integration, users are directed to PJM's Single Sign-On application

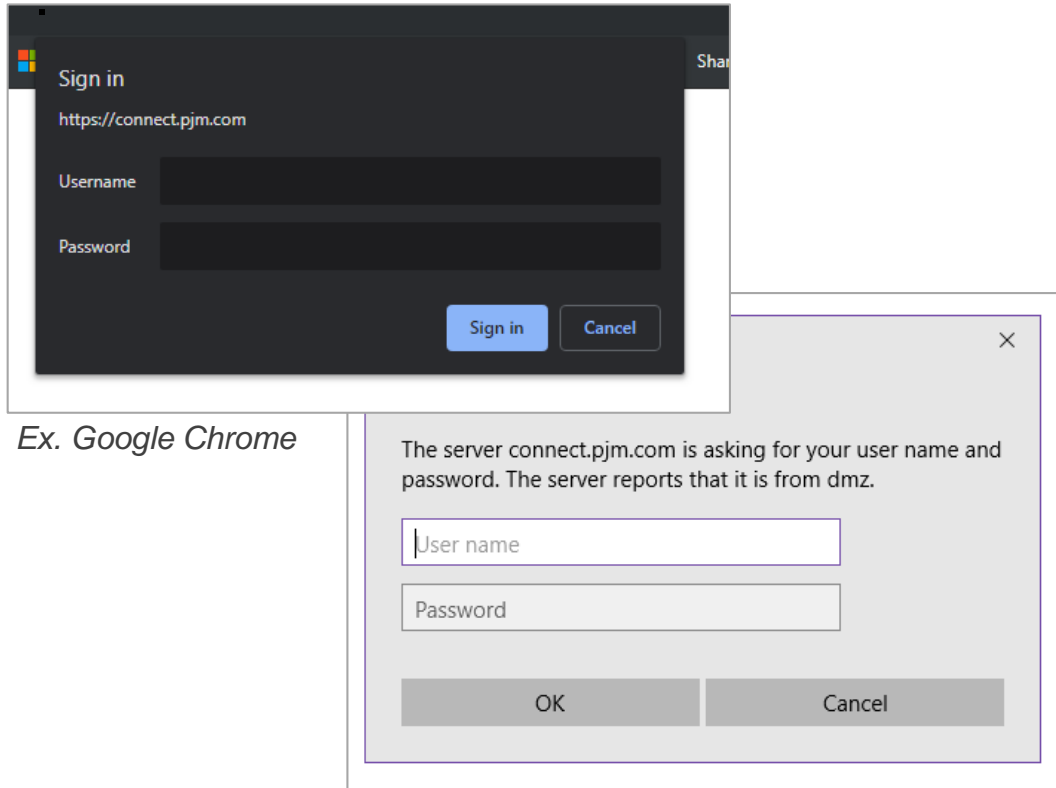

Ex. Google Chrome

Ex. Windows Internet Explorer



Some users/companies have reported difficulty logging into PJM Connect. After investigating with Microsoft support and internal subject matter experts, external user's network and/or browser settings appear to be the root cause.

If you continue to experience issues, please contact coordinate with your internal IT support and PJM Connect Support for assistance with troubleshooting.

Report issues or submit questions to:

- PJM's [Member Relations](#) or call (610) 666-8980
- SharePointConnectAdmins@pjm.com
- Your site's PJM employee owner

Tech Change Forum

- [Educational recording](#)



Product Details

PJM Connect, PJM's external SharePoint site, allows PJM personnel and external stakeholders to collaborate and share data.

Key Product Features

- Enables users to create robust, individualized sites to organize their projects, initiatives and tasks specific to their needs
- Using SharePoint apps, users can organize document submissions, data sets and calendars all in one site