



PJM Connect Roadmap

As of June 16, 2020

- Added information about resolving login issues

Product - Action Required	Dates	Who May Be Affected
Implementation: PJM Connect integration with PJM's Single Sign On (SSO)	July 9 5:00 p.m.	PJM Connect users



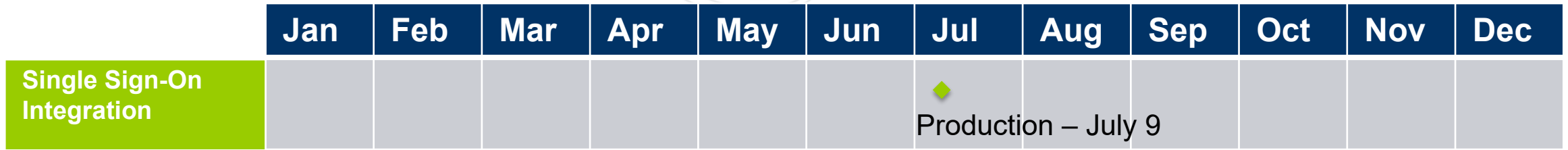

Legend

- Start Date
- ◆ End Date



Currently, PJM Connect prompts users for their accounts via the web browser; must use the following format: DMZ\username

After integration, users will be directed to PJM's Single Sign-On application

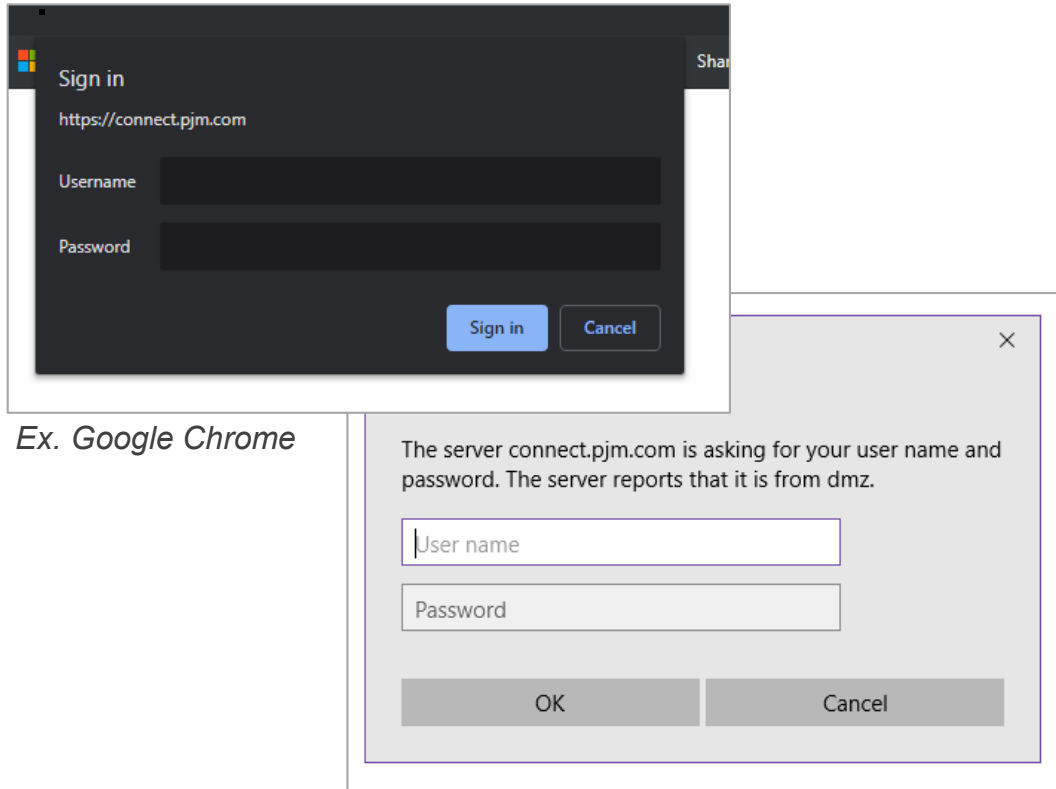

Ex. Google Chrome

Ex. Windows Internet Explorer



Some users/companies have reported difficulty logging into PJM Connect. After investigating with Microsoft support and internal subject matter experts, external user's network and/or browser settings appear to be the root cause.

- Immediate action: Coordinate with your internal IT support and PJM Connect Support for assistance with troubleshooting.
- Short-term solution: Use [Secure Share](#) to share files with PJM.
- Long-term solution: Integration with PJM's Single Sign On application on Thursday, July 9.

Report issues or submit questions to:

- PJM's [Member Relations](#) or call (610) 666-8980
- SharePointConnectAdmins@pjm.com
- Your site's PJM employee owner

Tech Change Forum

- [Educational recording](#)

Product Details

PJM Connect, PJM's external SharePoint site, allows PJM personnel and external stakeholders to collaborate and share data.

Key Product Features

- Enables users to create robust, individualized sites to organize their projects, initiatives and tasks specific to their needs
- Using SharePoint apps, users can organize document submissions, data sets and calendars all in one site