



# Connect.pjm.com Roadmap

As of April 16, 2020

- Implementation date for SSO integration updated to Sunday, May 24 at 5:00 p.m.

Product - Action Required	Dates	Who May Be Affected
<b>Implementation:</b> Connect.pjm.com integration with PJM's Single Sign On (SSO)	<b>May 24</b> <b>5:00 p.m.</b>	Connect.pjm.com users





**Legend**

- Start Date
- ◆ End Date



Currently, connect.pjm.com prompts users for their accounts via the web browser; must use the following format: DMZ\username

After integration, users will be directed to PJM's Single Sign-On application

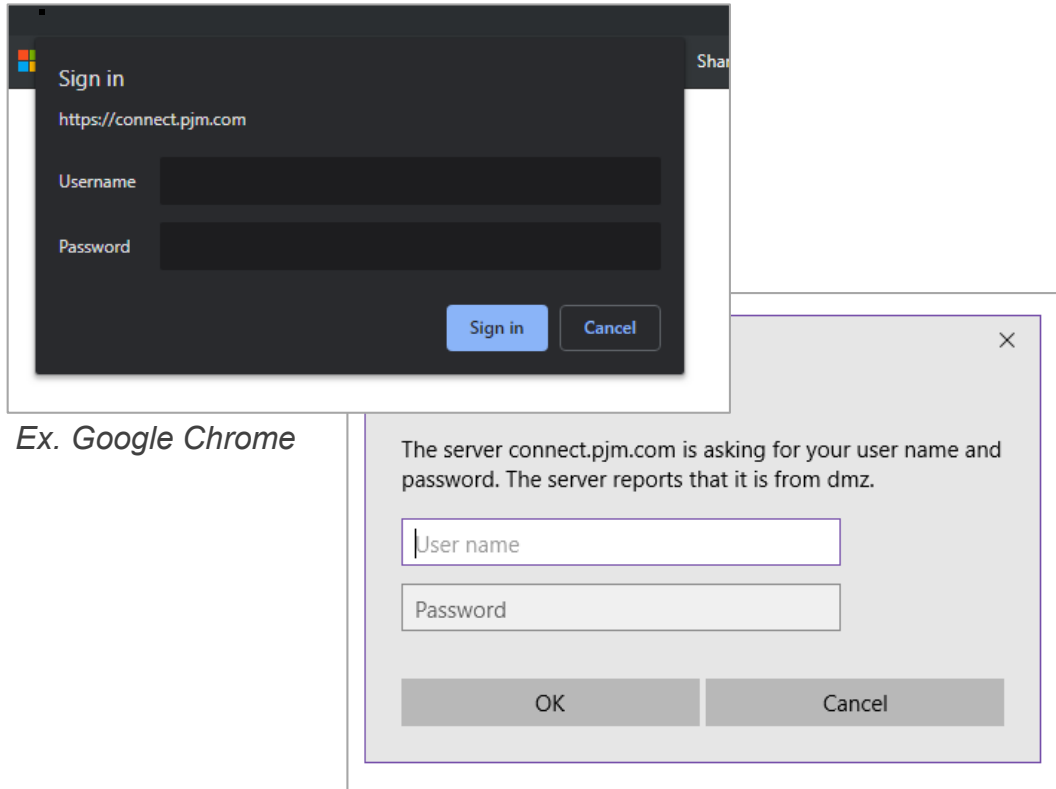

Ex. Google Chrome

Ex. Windows Internet Explorer



Report issues or submit questions to:

- PJM's [Member Relations](#) or call 610-666-8980
- [SharePointConnectAdmins@pjm.com](mailto:SharePointConnectAdmins@pjm.com)
- Your site's PJM employee owner

Tech Change Forum

- [Educational recording](#)

# Product Details

Connect.pjm.com, PJM's external SharePoint site, allows PJM personnel and external stakeholders to collaborate and share data.

## **Key Product Features**

- Enables users to create robust, individualized sites to organize their projects, initiatives and tasks specific to their needs
- Using SharePoint apps, users can organize document submissions, data sets and calendars all in one site